



Welcome to Gaylord Rockies!

When you plan a meeting at Gaylord Hotels, you really can have it all. We offer a legacy of experience and dedication that guarantees a memorable, customized, one-of-a-kind event. Our “everything in one place” approach ensures that your group maximizes its time together, while unrivaled meetings expertise and exemplary service standards ensure a thoroughly successful, stress-free experience for both you and your attendees. As the premier Colorado meeting and convention center hotel, Gaylord Rockies Resort & Convention Center provides the perfect backdrop for bringing your best ideas to life. Let our passion for meetings inspire you!

Extraordinary environments, meetings expertise, and service with a passion — all under one spectacular roof.

Dedication to these principles is what sets Gaylord Hotels apart, and it’s the secret to your next successful meeting.

TABLE OF CONTENTS

- 2 Resort Overview
- 6 Overview Map
- 7 Convention Center Level Map

CONVENTION & MEETING SPACE

- 8 Adams Ballroom & Meeting Space
Adams Ballroom; Cottonwood, Maple & Spruce Meeting Rooms
- 10 Juniper Ballroom & Meeting Space
Juniper Ballroom; Hogan Boardroom, Mitzner, Charlton & Mitchell Meeting Rooms
- 12 Aurora Ballroom & Exhibit Hall
Aurora Ballroom, Aurora Exhibit Hall
- 14 Aurora Meeting Space
Summit, Crest & Valley Meeting Rooms
- 16 Colorado Ballroom & Meeting Space
Colorado Ballroom; Red Rock, Willow Lake & Homestead Meeting Rooms

FLEX SPACE

- 18 Restaurants & Lounges



Meet the Premier Colorado Meeting and Convention Center & Resort

Located in the idyllic All-American City of Aurora, Gaylord Rockies features winding waterways and picture perfect sunset views. Rustic alpine charm and exciting “open-air” activity make this Rocky Mountain Front Range retreat an adventure in itself.

*“Everything you need,
all in one place”*

With over 485,000 square feet of flexible meeting space and a wide range of unique networking venues, Gaylord Rockies offers everything you need, all in one place. Our signature Old Hickory Steakhouse provides a sophisticated spot for entertaining, while the resort pool and lazy river complex

is perfect for rollover stays with the family. Networking spots within our beautiful Grand Lodge and throughout the resort ensure that your group maximizes its time together. Keep the conversation going during dinner and beyond at one of our delicious restaurants and bars, or enhance your meeting experience with a soothing treatment at Relâche Spa.

Whatever your activity, you can be sure that our employee—who we refer to as “STARS”—will provide a world-class service experience like no other. Combining the magnificence of our spectacular resort with this unrivaled personal touch guarantees the increased flexibility and efficiency you need to create your perfect meeting.

Quick Facts

- 10 minutes from Denver International Airport
- 1,501 guest rooms, including 114 luxurious suites
- Over 485,000 sq. ft. of flexible meeting, convention, outdoor, exhibit & pre-function space
 - 175,000 sq. ft. Exhibit Hall
 - Four ballrooms from 7,500 to 59,467 sq. ft.
 - Up to 78 technologically advanced breakout and conference rooms
 - 22,000 sq. ft. Aurora Patio
 - 18,000 sq. ft. Veranda
 - Three outdoor event lawns from 13,200 to 39,790 sq. ft.
- Unique spaces for networking and social events
- An array of dining options, from fine dining at our signature Old Hickory Steakhouse to casual fare at Vista Montagne to grab & go
- Full service Relâche Spa and Salon
- State-of-the-art fitness center
- Arapahoe Springs pool and lazy river
- Exclusive retail shop featuring Colorado-inspired gifts and apparel
- Access to the A Line, Denver's new airport rail with service to downtown Denver







Meet the Extraordinary at Gaylord Rockies

When it comes to planning meetings, think of Gaylord Rockies as a canvas for your creativity—and our conference coordinators as your artistic collaborators. From breakout room to boardroom, exhibit hall to performance stage, conference for 10 to reception for 16,000, no matter what size or style of meeting you're imagining, the seasoned staff at Gaylord Rockies is passionate about bringing your ideas to life.

Whatever the scope of your event, our STARS are here to make it happen. Gaylord Rockies' meeting professionals are your true partners in planning, preparation and execution. Ask our clients,

and they'll tell you it's the STARS who make meetings at our resort so exceptional. From award-winning catering to marketing tools and technology support, our enthusiastic team is equally as invested in

***"Think of Gaylord Rockies
as a canvas for your creativity"***

the success of your business as you are, and we demonstrate that commitment every step of the way.



Overview Map

Map is based on original blueprints and is subject to change.

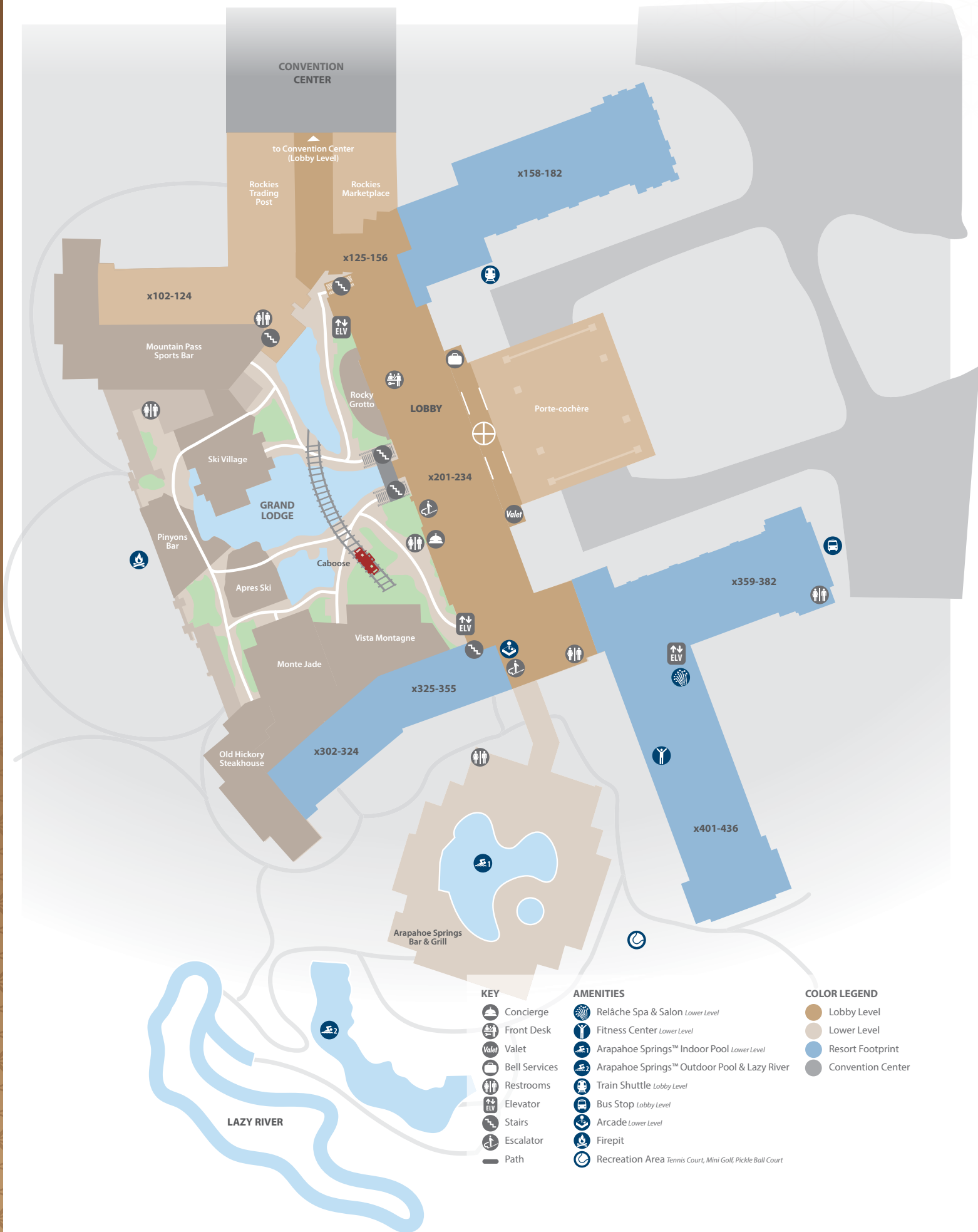

KEY

- Concierge
- Front Desk
- Valet
- Bell Services
- Restrooms
- Elevator
- Stairs
- Escalator
- Path

AMENITIES

- Relâche Spa & Salon *Lower Level*
- Fitness Center *Lower Level*
- Arapahoe Springs™ Indoor Pool *Lower Level*
- Arapahoe Springs™ Outdoor Pool & Lazy River
- Train Shuttle *Lobby Level*
- Bus Stop *Lobby Level*
- Arcade *Lower Level*
- Firepit
- Recreation Area *Tennis Court, Mini Golf, Pickle Ball Court*

COLOR LEGEND

- Lobby Level
- Lower Level
- Resort Footprint
- Convention Center

Colorado Ballroom - Level 3

- A** Colorado Ballroom
- B** Red Rock, Willow Lake & Homestead Meeting Rooms

Aurora Ballroom & Exhibit Hall - Level 2 (Lobby Level)

- C** Summit, Crest & Valley Meeting Rooms
- D** Aurora Ballroom
- E** Aurora Exhibit Hall

Adams Ballroom - Level 1

- F** Adams Ballroom
- G** Cottonwood, Maple & Spruce Meeting Rooms
- H** Hogan Boardroom, Mitzner, Charlton & Mitchell Meeting Rooms
- I** Juniper Ballroom

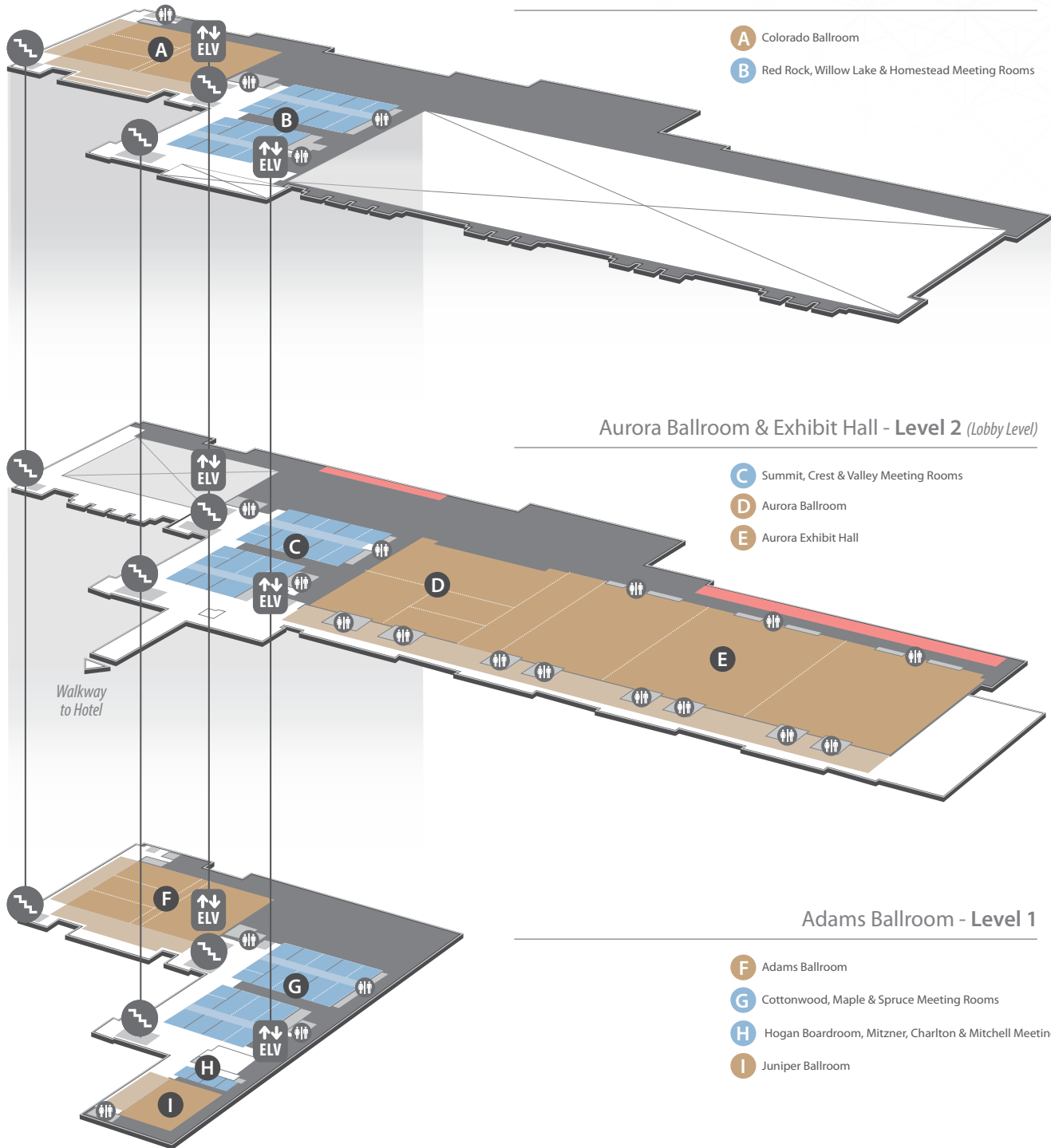



Adams Ballroom & Meeting Space

- KEY**
- Restrooms
 - Stairs
 - Registration Desks
 - Service Areas
 - Elevator
 - Escalator
 - Storage/Office
 - Load-in Doors

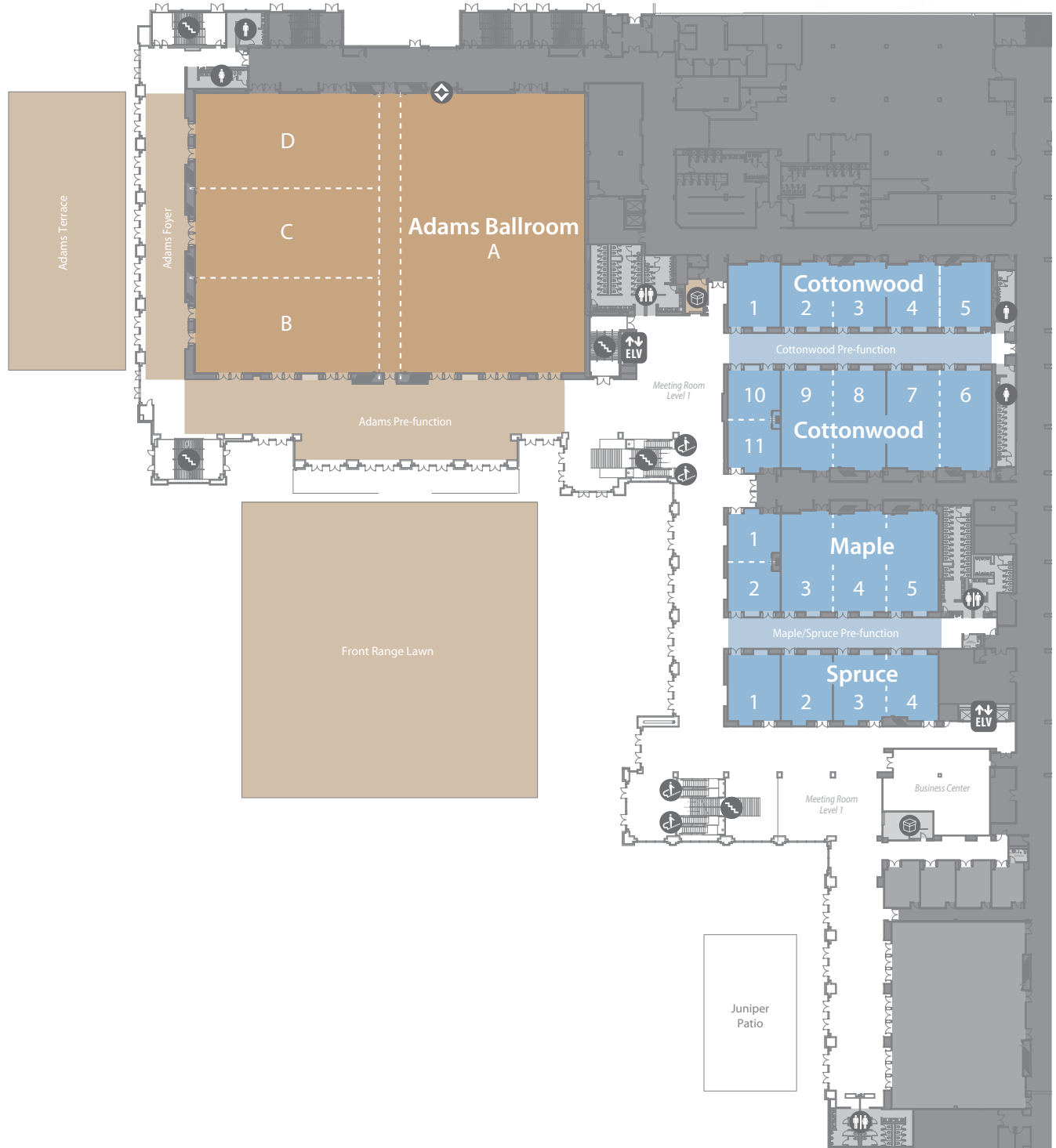

| BALLROOM | L X W X H (FEET) | SQ.FT. | THEATER | CLASSROOM | CONFERENCE | U-SHAPE | ROUNDS (10) | RECEPTION |
|-------------------------|---------------------|--------|--------------|-----------|------------|---------|-------------|-----------|
| ADAMS BALLROOM | 219x157x28 | 34,476 | 3,885 | 2,184 | | | 2,040 | 3,162 |
| A | 103x157x28 | 16,287 | 1,794 | 1,008 | | | 1,040 | 1,495 |
| B | 104x53x28 | 5,515 | 550 | 342 | | | 320 | 512 |
| C | 104x50x28 | 5,206 | 540 | 342 | | | 320 | 475 |
| D | 104x53x28 | 5,566 | 621 | 342 | | | 320 | 512 |
| Access Corridor A / BCD | 12x157x28 | 1,899 | | | | | | |
| Adams Pre-function | 230x45x35 | 9,987 | | | | | | 908 |
| Adams Foyer | 173x25x35 | 4,366 | | | | | | 451 |
| Adams Terrace | 165x80 | 13,200 | | | | | | 1,200 |
| Front Range Lawn | 230x173 | 39,790 | | | | | | 3,600 |
| Adams Storage | | 214 | | | | | | |

| MEETING SPACE | L X W X H (FEET) | SQ.FT. | THEATER | CLASSROOM | CONFERENCE | U-SHAPE | ROUNDS (10) | RECEPTION |
|---------------------------|---------------------|--------|------------|-----------|------------|---------|-------------|-----------|
| COTTONWOOD | | | | | | | | |
| 1 | 35x29x14 | 1,069 | 112 | 72 | 28 | 33 | 60 | 102 |
| 2/3 | 35x59x14 | 2,144 | 232 | 144 | 48 | 54 | 140 | 201 |
| 2 | 35x29x14 | 1,059 | 112 | 72 | 28 | 33 | 60 | 102 |
| 3 | 35x30x14 | 1,085 | 112 | 72 | 28 | 33 | 60 | 102 |
| 4/5 | 35x59x14 | 2,142 | 232 | 144 | 48 | 54 | 140 | 201 |
| 4 | 35x30x14 | 1,081 | 112 | 72 | 28 | 33 | 60 | 102 |
| 5 | 35x29x14 | 1,061 | 112 | 72 | 28 | 33 | 60 | 102 |
| 6/7 | 55x59x14 | 3,291 | 392 | 240 | 48 | 63 | 230 | 309 |
| 6 | 55x29x14 | 1,640 | 182 | 120 | 48 | 51 | 90 | 156 |
| 7 | 55x30x14 | 1,675 | 182 | 120 | 48 | 51 | 90 | 156 |
| 8/9 | 55x59x14 | 3,314 | 392 | 240 | 48 | 63 | 230 | 309 |
| 8 | 55x30x14 | 1,675 | 182 | 120 | 48 | 51 | 90 | 156 |
| 9 | 55x29x14 | 1,639 | 182 | 120 | 48 | 51 | 90 | 156 |
| 10/11 | 55x29x14 | 1,598 | 167 | 108 | 48 | 54 | 80 | 151 |
| 10 | 28x29x14 | 812 | 81 | 48 | 18 | 24 | 40 | 75 |
| 11 | 27x29x14 | 787 | 81 | 48 | 18 | 24 | 40 | 75 |
| Cottonwood Pre-function | 158x17x13 | 3,094 | | | | | | 281 |
| MAPLE | | | | | | | | |
| 1/2 | 55x29x14 | 1,600 | 170 | 90 | 42 | 48 | 80 | 151 |
| 1 | 27x29x14 | 788 | 69 | 48 | 24 | 24 | 40 | 70 |
| 2 | 28x29x14 | 810 | 69 | 48 | 24 | 24 | 40 | 77 |
| 3/4/5 | 55x88x14 | 4,973 | 616 | 360 | 78 | 93 | 330 | 462 |
| 3 | 55x29x14 | 1,639 | 182 | 120 | 48 | 51 | 90 | 153 |
| 4 | 55x30x14 | 1,694 | 182 | 120 | 48 | 51 | 90 | 156 |
| 5 | 55x29x14 | 1,640 | 182 | 120 | 48 | 51 | 90 | 153 |
| Maple/Spruce Pre-function | 134x17x13 | 2,595 | | | | | | 236 |
| SPRUCE | | | | | | | | |
| 1 | 37x29x14 | 1,125 | 117 | 72 | 30 | 33 | 60 | 107 |
| 2 | 37x29x14 | 1,103 | 117 | 72 | 30 | 33 | 60 | 107 |
| 3/4 | 37x59x14 | 2,143 | 240 | 162 | 48 | 54 | 150 | 208 |
| 3 | 37x30x14 | 1,139 | 117 | 72 | 30 | 33 | 60 | 107 |
| 4 | 37x29x14 | 1,069 | 117 | 72 | 30 | 33 | 60 | 107 |

Capacities shown in this book are maximum for each room, with no staging or audio-visual, and should be used for reference only. Room capacities will be diminished based on your staging and audio-visual needs. Square footage and capacities are based on developer blueprints and are subject to change.



Juniper Ballroom and Boardrooms

- KEY**
- Restrooms
 - Stairs
 - Registration Desks
 - Service Areas
 - Elevator
 - Escalator
 - Storage/Office
 - Load-in Doors

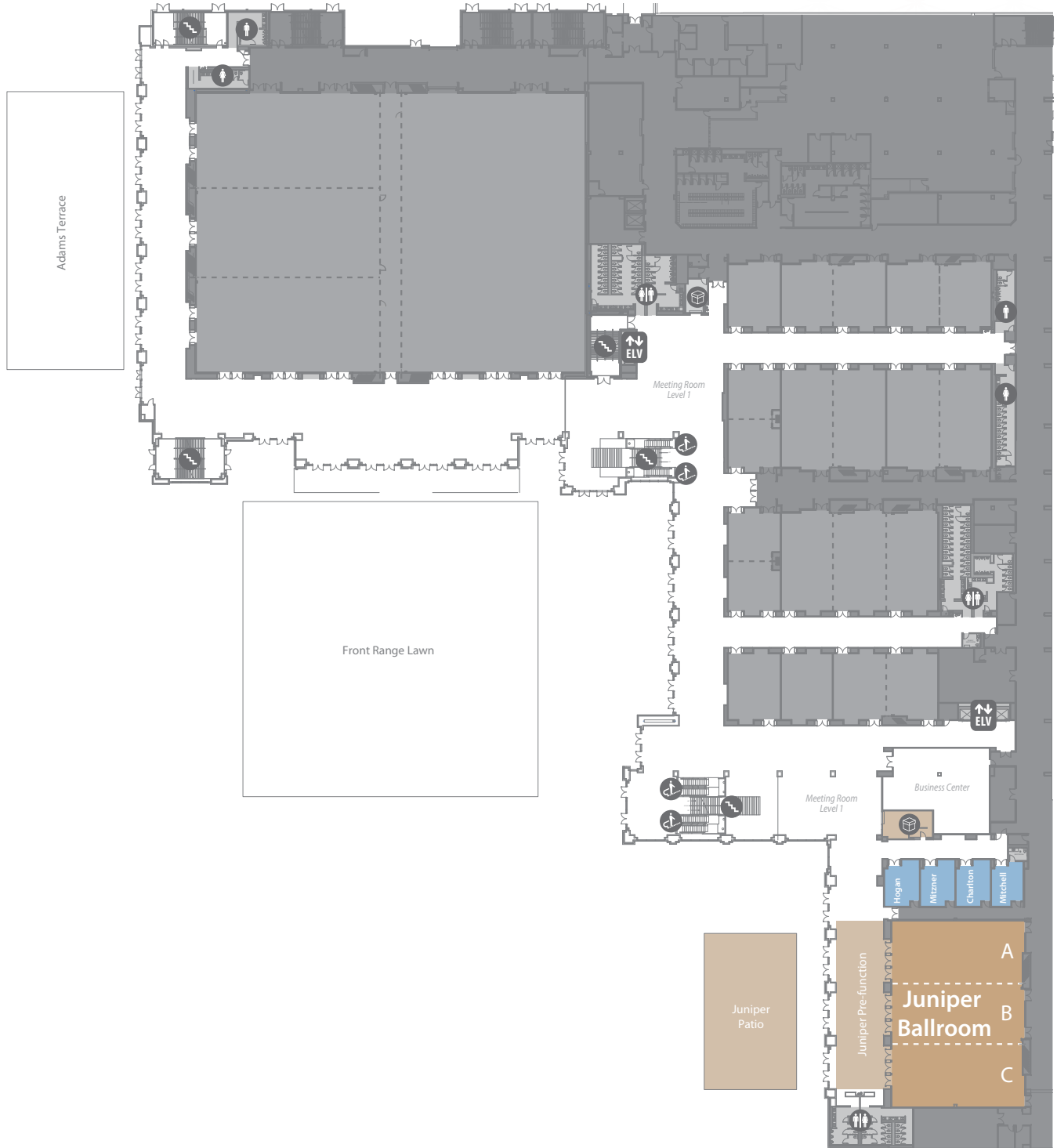

| SOCIAL BALLROOM | L X W X H (FEET) | SQ.FT. | THEATER | CLASSROOM | ROUNDS (10) | RECEPTION |
|----------------------|------------------|--------|------------|-----------|-------------|-----------|
| JUNIPER | 105x73x18 | 7,535 | 700 | 468 | 400 | 718 |
| A | 73x35x18 | 2,514 | 221 | 141 | 100 | 242 |
| B | 73x34x18 | 2,519 | 221 | 141 | 100 | 232 |
| C | 73x36x18 | 2,566 | 221 | 141 | 100 | 243 |
| Juniper Pre-function | 147x31x16 | 4,761 | | | | 433 |
| Juniper Patio | 95x142 | 13,444 | | | | 900 |
| Juniper Office | | 438 | | | | |

| MEETING SPACE | L X W X H (FEET) | SQ.FT. | THEATER | CLASSROOM | CONFERENCE | U-SHAPE | ROUNDS (10) | RECEPTION |
|-----------------|------------------|--------|-----------|-----------|------------|---------|-------------|-----------|
| MITZNER | 23x19x14 | 451 | 40 | 18 | 18 | 15 | 20 | 43 |
| CHARLTON | 23x19x14 | 451 | 40 | 18 | 18 | 15 | 20 | 43 |
| MITCHELL | 23x18x14 | 395 | 40 | 18 | 18 | 15 | 20 | 38 |

| BOARDROOM | L X W X H | SQ.FT. | THEATER | CLASSROOM | CONFERENCE | U-SHAPE | ROUNDS (10) | RECEPTION |
|--------------|-----------|--------|---------|-----------|------------|---------|-------------|-----------|
| HOGAN | 23x20x14 | 458 | | | | 10 | | |

Capacities shown in this book are maximum for each room, with no staging or audio-visual, and should be used for reference only. Room capacities will be diminished based on your staging and audio-visual needs. Square footage and capacities are based on developer blueprints and are subject to change.



Photograph: Juniper Patio and Pavillion



Aurora Ballroom & Exhibit Hall

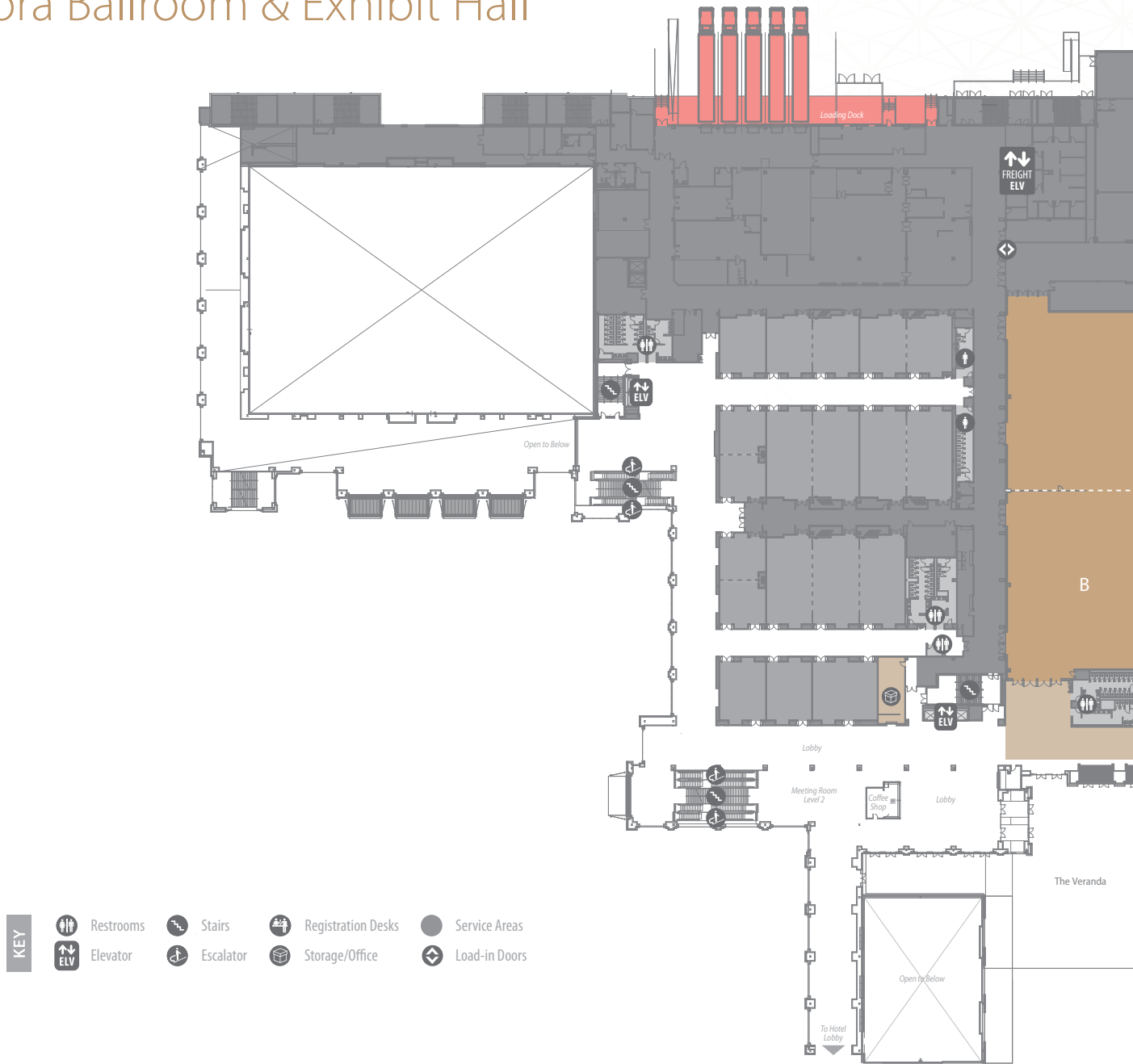

Photograph: Aurora Ballroom

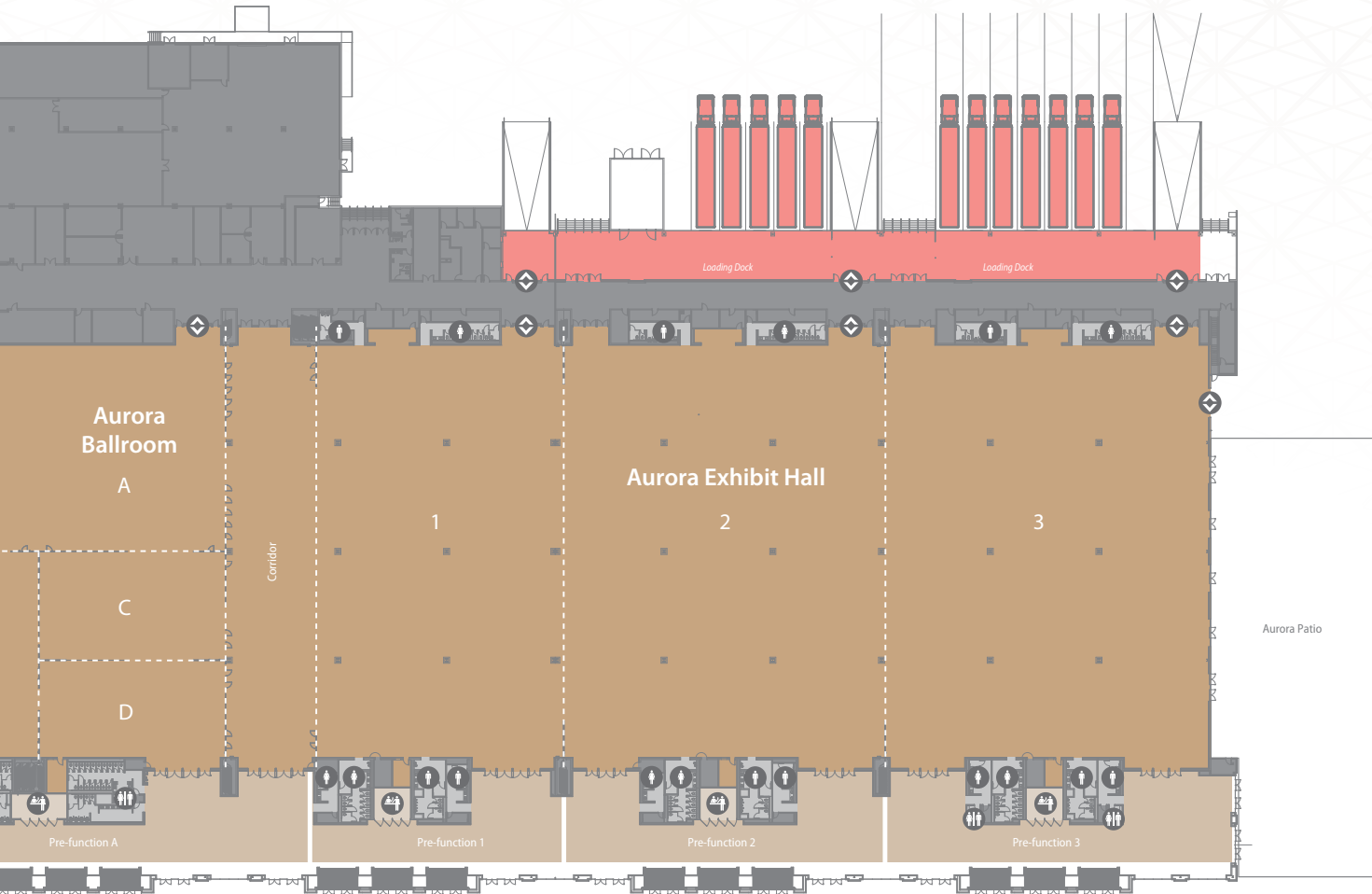

| BALLROOM & EXHIBIT HALL | LXWXH (FEET) | SQ.FT. | THEATER | CLASSROOM | ROUNDS (10) | RECEPTION | 8 X 10 BOOTHS | 10 X 10 BOOTHS |
|----------------------------|--------------|---------|--------------|-----------|-------------|-----------|---------------|----------------|
| AURORA | 747x227x30 | 174,115 | 19,208 | 11,088 | 10,580 | 15,865 | 1,011 | 856 |
| Pre-function A / 123 | 764x59x28 | 32,927 | | | | | | |
| Aurora Ballroom | 205x227x36 | 47,573 | 4,809 | 2,976 | 2,550 | 4,382 | 296 | 244 |
| A | 205x114x36 | 23,816 | 2,024 | 1,332 | 1,350 | 2,173 | | |
| B | 102x114x36 | 11,813 | 1,185 | 660 | 630 | 1,079 | | |
| C | 103x60x36 | 6,180 | 624 | 378 | 320 | 562 | | |
| D | 103x54x36 | 5,766 | 528 | 324 | 320 | 526 | | |
| Pre-function A | 255x59x28 | 11,941 | | | | | | |
| Registration Desk | | 588 | | | | | | |
| Aurora Exhibit Hall | 493x227x30 | 114,648 | | | | | 649 | 558 |
| 1 | 137x227x30 | 31,660 | 2,378 | 1,578 | 1,530 | 2,879 | 179 | 140 |
| 2 | 177x227x30 | 41,258 | 4,102 | 2,364 | 2,110 | 3,757 | 238 | 210 |
| 3 | 179x227x30 | 41,730 | 4,102 | 2,364 | 2,110 | 3,799 | 232 | 208 |
| Pre-function 1 | 137x59x28 | 5,131 | | | | | | |
| Pre-function 2 | 177x59x28 | 7,454 | | | | | | |
| Pre-function 3 | 179x59x28 | 8,401 | | | | | | |
| 3 Registration Desks | | 475 | | | | | | |
| Corridor (Ballroom / 123) | 50x227x30 | 11,894 | | | | 1,090 | 66 | 54 |
| Aurora Patio | 91x279 | 22,242 | | | | 1,818 | | |
| The Veranda | | 18,122 | | | | 1,000 | | |
| Aurora Storage/Office | 17x36 | 619 | | | | | | |

Capacities shown in this book are maximum for each room, with no staging or audio-visual, and should be used for reference only. Room capacities will be diminished based on your staging and audio-visual needs. Square footage and capacities are based on developer blueprints and are subject to change.



Aurora Meeting Space

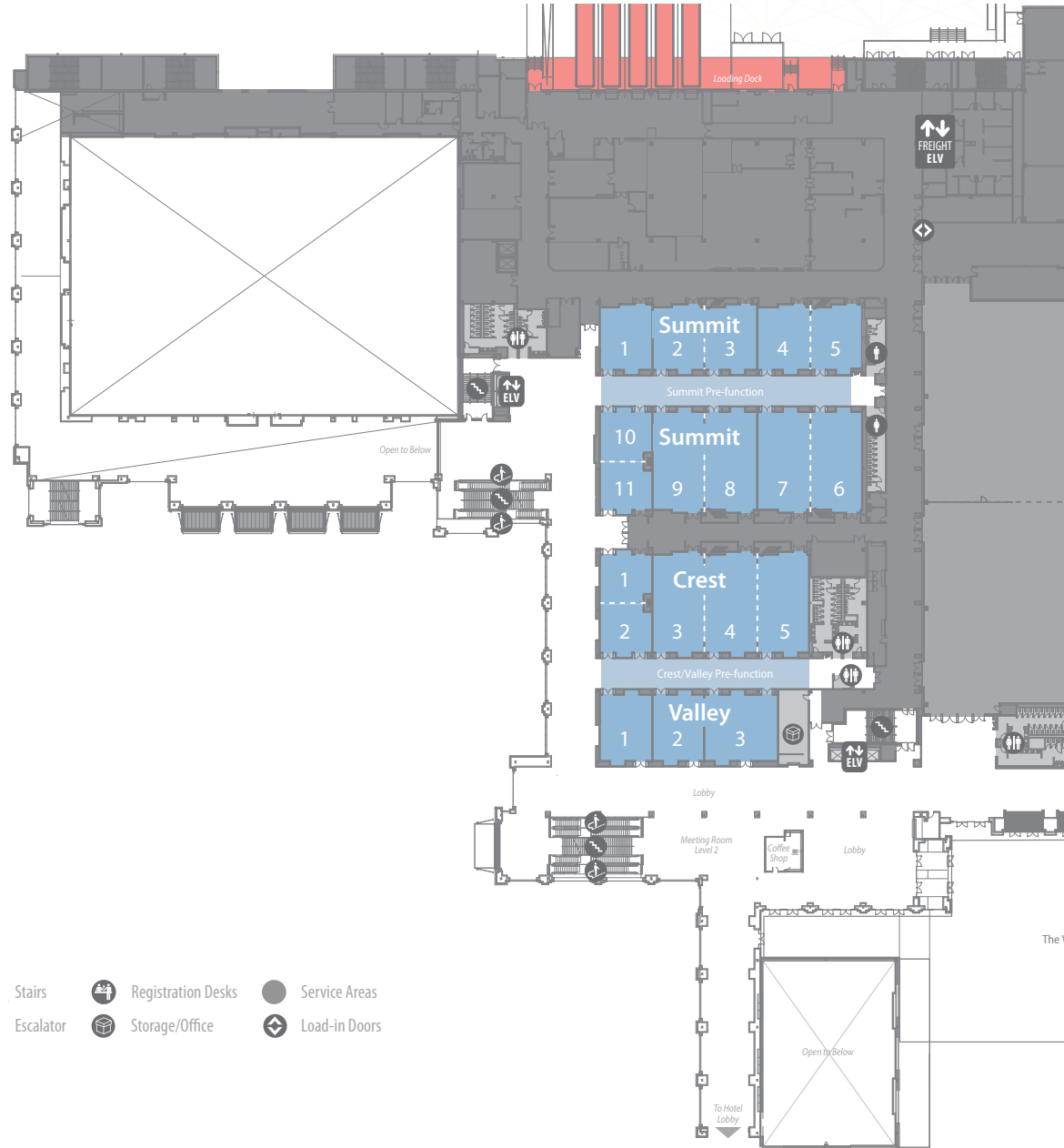

- KEY**
- Restrooms
 - Stairs
 - Registration Desks
 - Service Areas
 - Elevator
 - Escalator
 - Storage/Office
 - Load-in Doors

| MEETING SPACE | L X W X H (FEET) | SQ.FT. | THEATER | CLASSROOM | CONFERENCE | U-SHAPE | ROUNDS (10) | RECEPTION |
|---------------|------------------|--------|------------|-----------|------------|---------|-------------|-----------|
| SUMMIT | | | | | | | | |
| 1 | 35x29x14 | 1,069 | 112 | 72 | 28 | 33 | 60 | 102 |
| 2/3 | 35x59x14 | 2,144 | 232 | 144 | 48 | 54 | 140 | 201 |
| 2 | 35x29x14 | 1,059 | 112 | 72 | 24 | 33 | 60 | 100 |
| 3 | 35x30x14 | 1,085 | 112 | 72 | 24 | 33 | 60 | 102 |
| 4/5 | 35x59x14 | 2,143 | 232 | 144 | 48 | 54 | 150 | 201 |
| 4 | 35x30x14 | 1,081 | 112 | 72 | 28 | 33 | 60 | 102 |
| 5 | 35x29x14 | 1,061 | 112 | 72 | 28 | 33 | 60 | 100 |
| 6/7 | 55x59x14 | 3,291 | 392 | 240 | 48 | 63 | 230 | 309 |
| 6 | 55x29x14 | 1,640 | 182 | 120 | 48 | 51 | 90 | 153 |
| 7 | 55x30x14 | 1,675 | 182 | 120 | 48 | 51 | 90 | 156 |
| 8/9 | 55x59x14 | 3,314 | 392 | 240 | 48 | 63 | 230 | 309 |
| 8 | 55x30x14 | 1,675 | 182 | 120 | 48 | 51 | 90 | 156 |
| 9 | 55x29x14 | 1,640 | 182 | 120 | 48 | 51 | 90 | 153 |

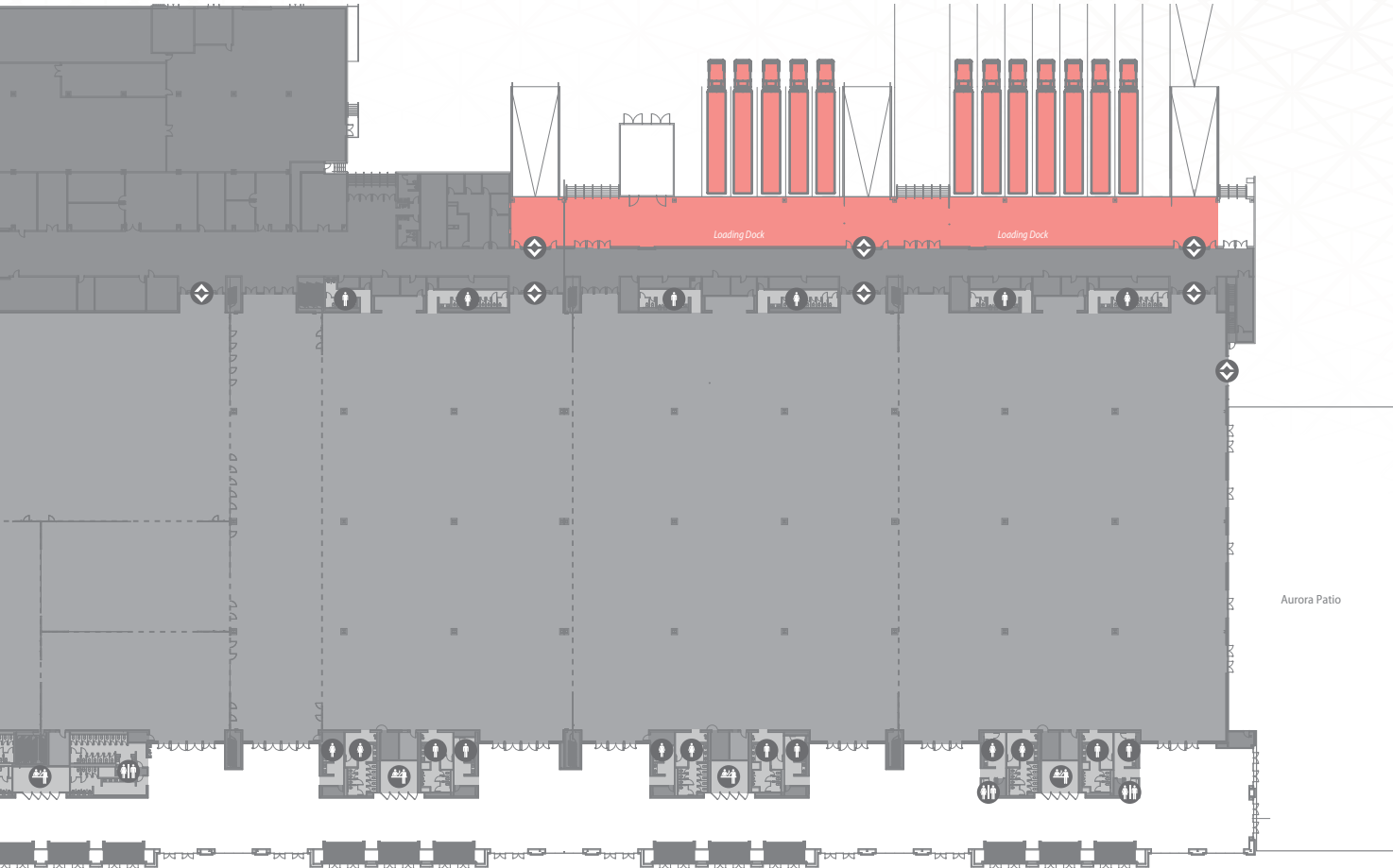

| MEETING SPACE | L X W X H (FEET) | SQ.FT. | THEATER | CLASSROOM | CONFERENCE | U-SHAPE | ROUNDS (10) | RECEPTION |
|--------------------------------|---------------------|--------|------------|-----------|------------|---------|-------------|-----------|
| SUMMIT <i>continued</i> | | | | | | | | |
| 10/11 | 55x29x14 | 1,599 | 167 | 108 | 48 | 54 | 80 | 151 |
| 10 | 28x29x14 | 811 | 81 | 48 | 18 | 24 | 40 | 77 |
| 11 | 27x29x14 | 788 | 81 | 48 | 18 | 24 | 40 | 75 |
| Summit Pre-function | 158x17x13 | 3,094 | | | | | | 281 |
| CREST | | | | | | | | |
| 1/2 | 55x29x14 | 1,599 | 170 | 90 | 42 | 48 | 80 | 151 |
| 1 | 27x29x14 | 788 | 69 | 48 | 24 | 24 | 40 | 75 |
| 2 | 28x29x14 | 811 | 69 | 48 | 24 | 24 | 40 | 77 |
| 3/4/5 | 55x88x14 | 4,973 | 616 | 360 | 78 | 93 | 350 | 462 |
| 3 | 55x29x14 | 1,639 | 182 | 120 | 48 | 51 | 90 | 153 |
| 4 | 55x30x14 | 1,694 | 182 | 120 | 48 | 51 | 90 | 156 |
| 5 | 55x29x14 | 1,640 | 182 | 120 | 48 | 51 | 90 | 153 |
| Crest/Valley Pre-function | 134x17x13 | 2,595 | | | | | | 236 |
| VALLEY | | | | | | | | |
| 1 | 37x29x14 | 1,125 | 117 | 72 | 30 | 33 | 60 | 107 |
| 2 | 37x29x14 | 1,104 | 117 | 72 | 30 | 33 | 60 | 105 |
| 3 | 37x41x14 | 1,566 | 189 | 90 | 30 | 42 | 90 | 148 |

Capacities shown in this book are maximum for each room, with no staging or audio-visual, and should be used for reference only. Room capacities will be diminished based on your staging and audio-visual needs. Square footage and capacities are based on developer blueprints and are subject to change.



Colorado Ballroom & Meeting Space

- KEY**
- Restrooms
 - Stairs
 - Registration Desks
 - Service Areas
 - Elevator
 - Escalator
 - Storage/Office
 - Load-in Doors

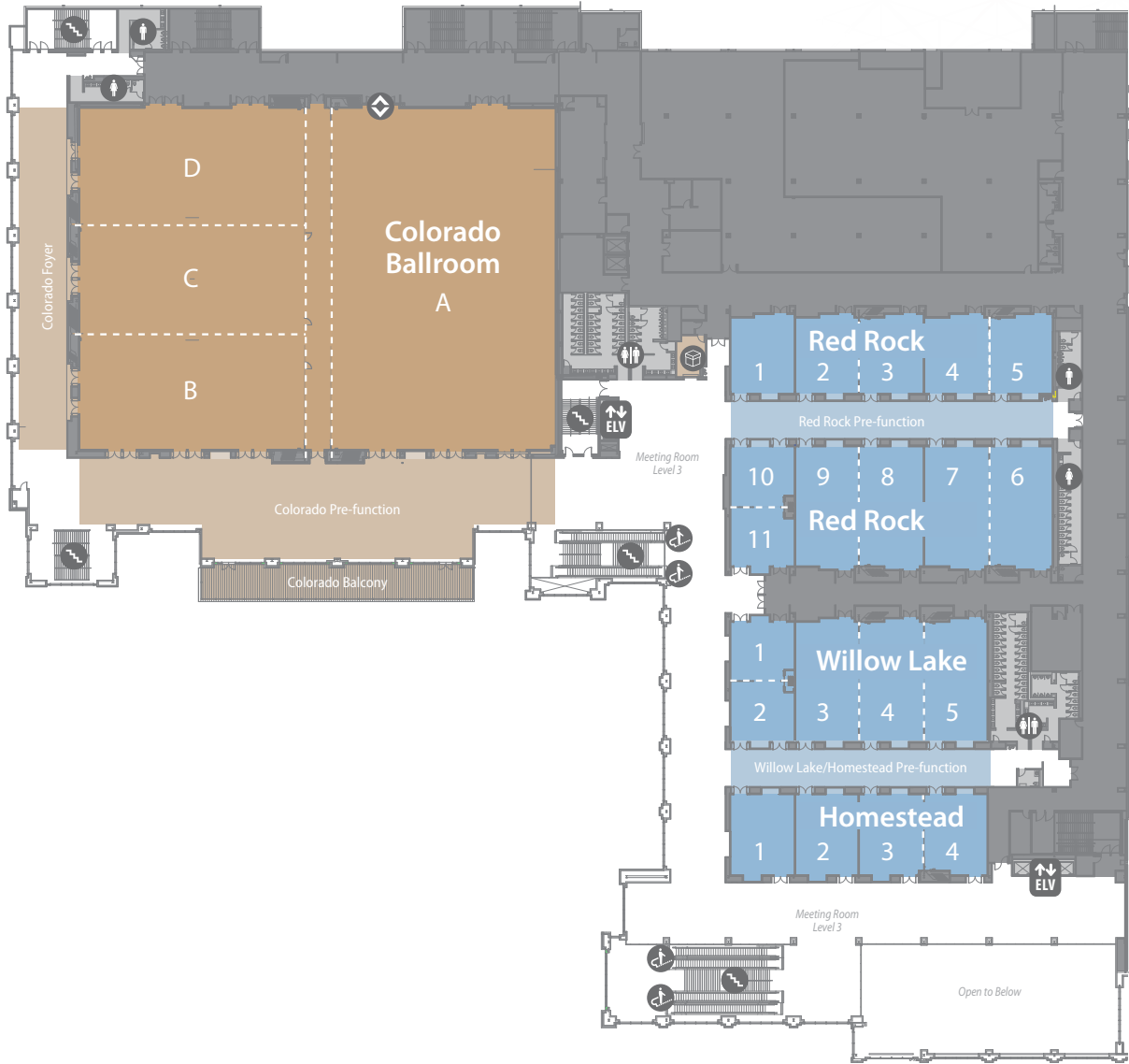

| BALLROOM | L X W X H (FEET) | SQ.FT. | THEATER | CLASSROOM | CONFERENCE | U-SHAPE | ROUNDS (10) | RECEPTION |
|--------------------------|------------------|--------|--------------|-----------|------------|---------|-------------|-----------|
| COLORADO BALLROOM | 219x157x28 | 34,463 | 3,959 | 2,184 | | | 2,040 | 3,162 |
| A | 103x157x28 | 16,264 | 1,920 | 1,008 | | | 1,040 | 1,495 |
| B | 104x53x28 | 5,520 | 600 | 342 | | | 320 | 507 |
| C | 104x50x28 | 5,210 | 540 | 342 | | | 320 | 475 |
| D | 104x53x28 | 5,568 | 621 | 342 | | | 320 | 512 |
| Access Corridor A / BCD | 12x157x28 | 1,899 | | | | | | |
| Colorado Pre-function | 230x45x28 | 10,597 | | | | | | 908 |
| Colorado Foyer | 187x25x28 | 4,367 | | | | | | 451 |
| Colorado Balcony | 16x15 | 1,934 | | | | | | 175 |
| Colorado Storage/Office | | 214 | | | | | | |

| MEETING SPACE | L X W X H (FEET) | SQ.FT. | THEATER | CLASSROOM | CONFERENCE | U-SHAPE | ROUNDS (10) | RECEPTION |
|-----------------------|------------------|--------|------------|-----------|------------|---------|-------------|-----------|
| RED ROCK | | | | | | | | |
| 1 | 35x29x14 | 1,069 | 112 | 72 | 28 | 33 | 60 | 102 |
| 2/3 | 35x59x14 | 2,144 | 232 | 144 | 48 | 54 | 140 | 201 |
| 2 | 35x29x14 | 1,059 | 112 | 72 | 28 | 33 | 60 | 100 |
| 3 | 35x30x14 | 1,084 | 112 | 72 | 28 | 33 | 60 | 102 |
| 4/5 | 35x59x14 | 2,143 | 232 | 144 | 48 | 54 | 140 | 201 |
| 4 | 35x30x14 | 1,081 | 112 | 72 | 28 | 33 | 60 | 102 |
| 5 | 35x29x14 | 1,061 | 112 | 72 | 28 | 33 | 60 | 100 |
| 6/7 | 55x59x14 | 3,312 | 392 | 240 | 48 | 63 | 220 | 309 |
| 6 | 55x29x14 | 1,638 | 182 | 120 | 48 | 51 | 90 | 153 |
| 7 | 55x30x14 | 1,673 | 182 | 120 | 48 | 51 | 90 | 156 |
| 8/9 | 55x59x14 | 3,312 | 392 | 240 | 48 | 63 | 230 | 309 |
| 8 | 55x30x14 | 1,674 | 182 | 120 | 48 | 51 | 90 | 156 |
| 9 | 55x29x14 | 1,638 | 182 | 120 | 48 | 51 | 90 | 153 |
| 10/11 | 55x29x14 | 1,605 | 167 | 108 | 48 | 54 | 80 | 151 |
| 10 | 28x29x14 | 811 | 81 | 48 | 18 | 24 | 40 | 77 |
| 11 | 27x29x14 | 734 | 81 | 48 | 18 | 24 | 40 | 75 |
| Red Rock Pre-function | 158x17x13 | 3,094 | | | | | | 281 |

| | | | | | | | | |
|------------------------------------|-----------|-------|------------|-----|----|----|-----|-----|
| WILLOW LAKE | | | | | | | | |
| 1/2 | 55x29x14 | 1,600 | 170 | 90 | 42 | 48 | 80 | 151 |
| 1 | 27x29x14 | 788 | 69 | 48 | 24 | 24 | 40 | 75 |
| 2 | 28x29x14 | 811 | 69 | 48 | 24 | 24 | 40 | 70 |
| 3/4/5 | 55x88x14 | 4,850 | 616 | 360 | 78 | 93 | 330 | 462 |
| 3 | 55x29x14 | 1,641 | 182 | 120 | 48 | 51 | 90 | 153 |
| 4 | 55x30x14 | 1,696 | 182 | 120 | 48 | 51 | 90 | 156 |
| 5 | 55x29x14 | 1,641 | 182 | 120 | 48 | 51 | 90 | 153 |
| Willow Lake/Homestead Pre-function | 134x17x13 | 2,595 | | | | | | |

| | | | | | | | | |
|------------------|----------|-------|------------|-----|----|----|-----|-----|
| HOMESTEAD | | | | | | | | |
| 1 | 37x29x14 | 1,127 | 117 | 72 | 30 | 33 | 60 | 107 |
| 2 | 37x29x14 | 1,104 | 117 | 72 | 30 | 33 | 60 | 105 |
| 3/4 | 37x59x14 | 2,144 | 240 | 162 | 48 | 54 | 150 | 208 |
| 3 | 37x30x14 | 1,140 | 117 | 72 | 30 | 33 | 60 | 107 |
| 4 | 37x29x14 | 1,070 | 117 | 72 | 30 | 33 | 60 | 100 |

Capacities shown in this book are maximum for each room, with no staging or audio-visual, and should be used for reference only. Room capacities will be diminished based on your staging and audio-visual needs. Square footage and capacities are based on developer blueprints and are subject to change.



FLEX-SPACE | RESTAURANT

Old Hickory Steakhouse



RESTAURANT FLEX-SPACE

EXISTING
SETUP (PPL)

OLD HICKORY

212

South Semi-Private Room

30

Capacities shown in this book are maximum for each room, with no staging or audio-visual, and should be used for reference only. Room capacities will be diminished based on your staging and audio-visual needs.

Mountain Pass & Pinyons



| RESTAURANT FLEX-SPACE | EXISTING SETUP (PPL) |
|-----------------------|----------------------|
| MOUNTAIN PASS | 519 |
| Upper Level | 220 |
| Lower Level | 299 |
| Falls Overlook | 20 |
| Private Room | 30 |

Capacities shown in this book are maximum for each room, with no staging or audio-visual, and should be used for reference only. Room capacities will be diminished based on your staging and audio-visual needs.

| GRAND LODGE FLEX-SPACE | EXISTING SETUP (PPL) |
|------------------------|----------------------|
| PINYONS | 90 |
| APRES SKI | 26 |

Capacities shown in this book are maximum for each room, with no staging or audio-visual, and should be used for reference only. Room capacities will be diminished based on your staging and audio-visual needs.



Photographs: (Top, Mountain Pass; Bottom, Pinyons)



FLEX-SPACE | RESTAURANT

Monte Jade & Vista Montagne

| RESTAURANT FLEX-SPACE | EXISTING SETUP (PPL) |
|-----------------------|----------------------|
| MONTE JADE | 151 |
| Terrace | 24 |
| Semi-Private Room | 20 |
| Private Dining West | 10 |
| Private Dining North | 10 |

Capacities shown in this book are maximum for each room, with no staging or audio-visual, and should be used for reference only. Room capacities will be diminished based on your staging and audio-visual needs.



Photographs: (Top, Monte Jade; Bottom Left, Vista Montagne; Bottom Right, Rocky Grotto)

| RESTAURANT FLEX-SPACE | EXISTING SETUP (PPL) |
|-----------------------|----------------------|
| VISTA MONTAGNE | 211 |
| Terrace | 52 |

Capacities shown in this book are maximum for each room, with no staging or audio-visual, and should be used for reference only. Room capacities will be diminished based on your staging and audio-visual needs.

| GRAND LODGE FLEX-SPACE | EXISTING SETUP (PPL) |
|------------------------|----------------------|
| ROCKY GROTTO | 56 |

Capacities shown in this book are maximum for each room, with no staging or audio-visual, and should be used for reference only. Room capacities will be diminished based on your staging and audio-visual needs.